

STONEWOOD VENTURES PVT LTD



# INTRODUCTION

Stonewood Ventures Pvt Ltd a pune based company working in hospitality industry. We are into Hospitality consultancy and providing solutions to our HNI clients Pan India. We help new and existing resorts, farmhouses, food malls, Restaurants, hotels to establish or revamp based on potential revenue for the location & hospitality standards. We answer questions like How much to invest? What is the ROI? Target audience ? What to design & develop ? How to operate? How to set up ? To know more visit [www.stonewood.in](http://www.stonewood.in)

## *PROCESS OF WORK*

Having Experience in hospitality industry, our management marketing, menu, kitchen team shares certain inputs with the Design team.

# PROCESS OF MARKET SURVEY



- Site visit
- Study of the location
- Study of access to the property
- Study of things to do
- Competition study
- Price analysis
- Set target audience



# FEASIBILITY REPORT



- 
- Average Revenue per Room finalizing based on the market study  
Working of expected Revenue for 5 to 7 years
  - Working of Fixed and variable Operational Expenses

## INPUTS FROM MANAGEMENT TEAM

1. Working on menu/kitchen equipments/amenities etc
2. Operationally suggesting do's and don't
3. Cost analysis as per location/property



# IDEATION AND CONSULTANCY



Ideation

- Offer various themes/concepts to the owner based on the feasibility report and market **NEED**
- Understand the vision of the owner and guide him to finalize **RIGHT** concept
- Create such a concept which will match with not only the investment but also to match with the environment.



- Create such a concept which will match the requirements of the guests
- Create such a concept which will have 100% Operational efficiency with huge savings in Operational costs.



The background features abstract geometric shapes. On the left, a large black curved shape is partially visible. On the right, a large orange curved shape is partially visible, with a smaller black curved shape below it. A thin grey horizontal line is positioned near the bottom left, overlapping the black shape.

RESORT/HOTEL/FARMHOUSE/  
DEVELOPMENT PROJECTS

# *NEW -AMARANTH BEACH RESORT, DAPOLI -MAHARASHTRA*





*EXISTING HOTEL - KOHINOOR HOLIDAY HOME, LONAVALA-MAHARASHTRA*



## *MEERA FARMS, VELHE NEAR PUNE*





# USEEKA RESORT , PANCHGANI IN MAHARASHTRA



# MASTER PLAN -ALIBAUG



# MASTER PLAN - PENCH NATIONAL PARK, M.P.

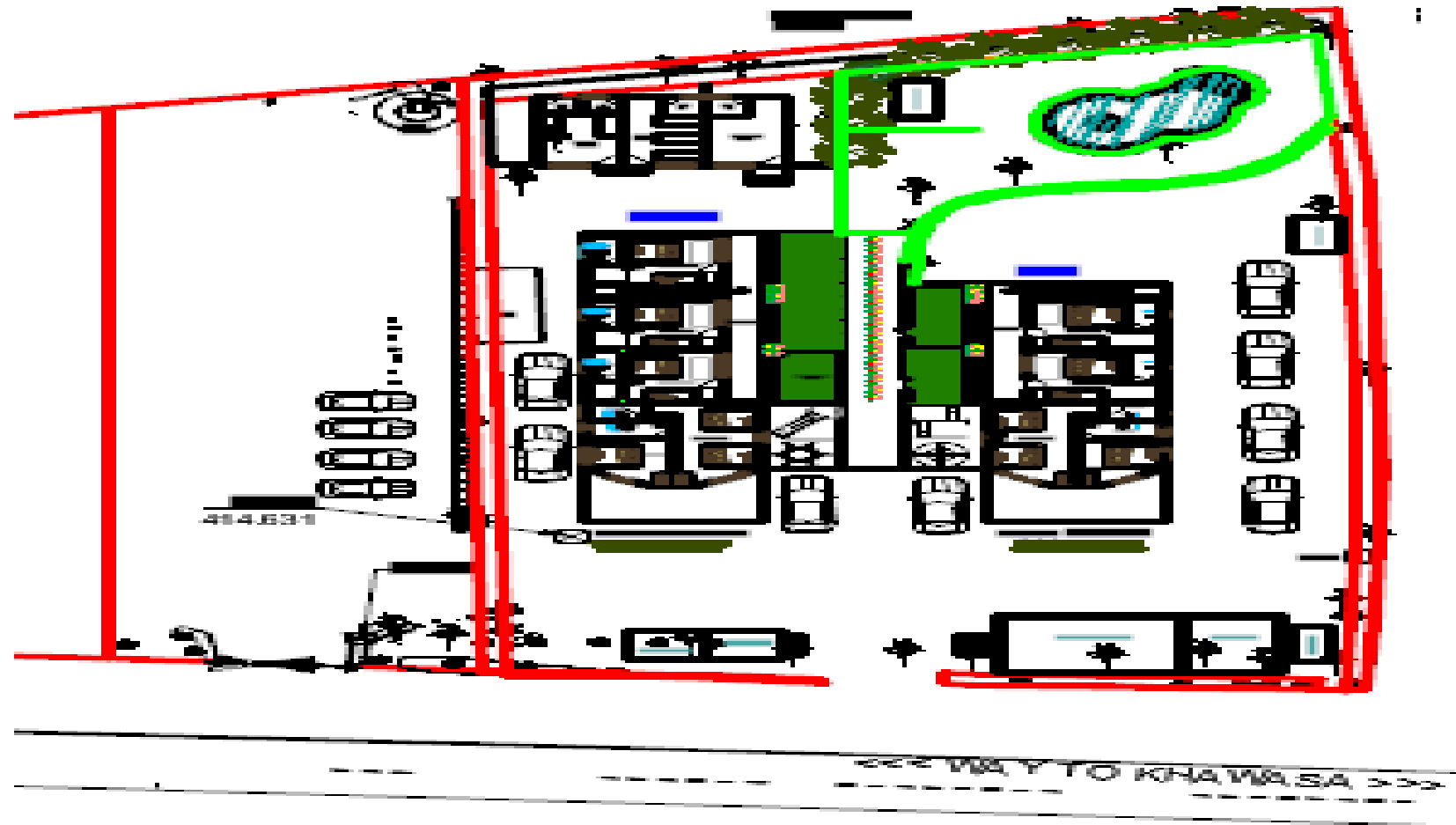



**RESTAURANT PROJECTS**  
**HOOKED AND 11EAST STREET**

# *11 EAST STREET RESTAURANT – PUNE, MAHARASHTRA*



# HOOKED RESTAURANT -PUNE MAHARASHTRA



## UNIQUE SELLING POINTS

- \* Knowledge of Revenue generation.
- \* Experience in hospitality industry.
- \* Market study /audit report
- \* Feasibility Report/ Audit report
- \* Designing with the help of marketing,operations,menu,kitchen inputs out of study.
- \* Helping in complete set up of rooms/kitchen/ restaurant.
- \* Recommend reasonable funds to invest & ROI against it.
- \* Support to get the staff / writing SOPs / training of staff.
- \* Deciding menu and revenue generation scope from F & B business
- \* Decide pricing policy & target audience.
- \* Tie up with resort management company ( for resort/ hotel/ farmhouses)
- \* We are a set of skilled professional having experience in hospitality with design skills. Offering all the above services under one roof.

# INTERIOR DESIGN

We also have a separate team for Interior designing right from residential places to resorts / hotels / restaurants / clubs / offices / Diagnostic Centers etc.









## CONTACT

Uday Soman +919987083400  
uday@stonewood.in

THANK YOU